



Foot Locker
U20
NATIONALS
PORIRUA 2026
TE RAUPARAHA ARENA
MAY 29 - JUNE 1

MAJOR PARTNER



HOSTS





BASKETBALL
New Zealand

Welcome to the
2026
Foot Locker U20
Nationals



INTRODUCTIONS



On behalf of Basketball New Zealand and your hosts Porirua Basketball Association, I would like to formally welcome teams and officials to the 2026 Foot Locker U20 Nationals.

TOURNAMENT OFFICIALS;

PORIRUA BASKETBALL

- Floor Controllers – Deslee Wrathall & Pene Hippolite
- Volunteer Manager – Deslee Wrathall

BASKETBALL NEW ZEALAND

- Basketball New Zealand Tournaments Lead & Tournament Director – Jay Macdonald
- Basketball New Zealand Events Coordinator & Te Ao Māori Lead – Tori Williams
- Basketball New Zealand Events Coordinators – Kieran Thomas & Libby Peckham
- Technical Commissioner – Campbell Marsters



REMINDERS

- EMAIL THROUGH THE FOLLOWING TO jay@nz.basketball
- TEAM CONTACT PERSON
- TEAM CONTACT PHONE NUMBER

- ONLINE ROSTERS MUST BE CONFIRMED TONIGHT
- PAST THIS POINT ONLY PLAYER NUMBERS OR REMOVING PLAYERS CAN CHANGE
- TEAM LISTS CANNOT BE CHANGED AT YOUR FIRST GAME
(unless error from our end)



Roster Checks - Men



Canterbury	Waikato Country	Harbour	Porirua
#4 Gus Dallow #5 Alex Stevens #6 Milan Newton #7 Toby Langrell #8 Mana Martin #9 Real Wheaton #10 Jack Yagmich #11 Ihaka Cate #12 Tommy Read #14 Jake Holmes	Aidan Hodgson Bronson Curtis Carter Jackways Dakotah Newton-King Dayton Henare Dylan Gibson Ezekial Te Maungarongo Akuhata Hozay Tito-Haitana Kaydyn Tauroa Reif Workman Tyson Taitoko-Turu Zephaniah Muraahi	#10 Nicholas Bamford #29 Mattie Dalton #34 Hunter Simmons #35 Harry Gerrard #38 Cooper Lepou #43 Harper Wilson #45 Ed Hamilton #51 Mathew Moors #52 Jordan Paterson #53 Tom Curteis #55 Kelvin Goldstein #71 Zen Lamb	#4 Tane Thomas #5 Klarence Barrenechea #6 Jonah Paenga #8 LaDanian Aranga-Tuilaepa #9 Isaiah Collins #10 Jonathan Pine #11 Fletcher Keene #12 Falken Mataipule #13 Lui Toomaga-Tapuai #14 Isaiah Kautai #15 Joshua Matatia #22 Cordell Wineera
Coach: Jayden Cameron Asst Coach: Tom Manley	Coach: John Auld Asst Coach: Tahi Turu Manager: Tania Enoka	Coach: Greg Brockbank Asst Coach: Jeff Wilson Manager: Lisa Folkard	Coach: Nixon Penese Manager: Julia Aranga-Tuilaepa

Men's Pool B

Taranaki	Waitakere West	Counties Manukau	Hutt Valley
#4 Jerome Tamatea #5 Jordan Cooper #6 Lyric Tuhaka #7 Kade Osborne #8 Rory Pepperell #9 William Campbell #10 Jacob Whitaker #12 Sam Walker #13 Kalem Cronin-Nwofor #15 Rakim Kavanagh	Bryan Morsters Carver Gibson Hunter Te Ratana Jeydin Ale Kingston Kailahi-Aso Kyle Buenafior Mahonri Schwalger Quincy Joblin Samuel Short Soane Tavite Tevita Tupou Valentino Swainson	#10 Everest Grant #14 Donovan Reckling #18 Jan Matanguihan #30 Jayden Chandra #48 Angelo Halafihi #54 Spencer Carr #67 Lucas Bennett-Pulu #68 Dresynn Tobin #79 Chisom Ochibulu #81 Henry Mayall #86 Hunter Wilkins #91 Elijah Price Mataroa	#0 Nikau Davis #1 Will Graham #2 Asher Turipa-Tapp #3 Mabei Makoi #4 Boston Perez-Peleti #7 Cooper Bouchereau #8 Leroy Grimmer #9 Reuben Leota #10 Akol Ater #17 Arana Robertson
Coach: Dwayne Tamatea Asst Coach: Tayla Robinson Manager: Deb Campbell	Coach: Jemma Palmer Manager: Zoe Fyhn	Coach: Milomilo Nanai Asst Coach: Enoch Marsters Manager: Supatra Bennett	Coach: Clayton Tapp Asst Coach: Jonty Wealleans Manager: Nikki Bouchereau

Men's Pool C

Franklin	Wellington	Auckland	Te Aroha
#3 Noah Williams #4 Nathaniel Short #5 Tama Schaumkel #6 Riley Fern #7 Ezekiel Otunuku #8 Harry Kelso #11 Isaiah Dunn #12 Cody Sheppard #14 Reuben Brooker #17 Kacius Tupaea #18 Jaxyn Bell #19 Braedyn Northcott	Achilles Leifi-Shirley Alex Beever Dov Silberstein Ernest Sullivan George Stent Liam Galt Mercury Nonu Niko Leifi-Shirley Stephon Tala Tom Van Driel Tui Howe Xavier Pivac Solomon	#8 Benjamin Wilson #14 Theo Chittenden #25 Hayden Robson #37 Logan Wood #39 Tyler Ngan #40 Jamie Griffin #54 Josh Beattie #57 Cameron Stewart #64 Harlyn King #74 Ari Taylor #99 Eskil Noonan Kaden Papera	#4 Kiwa Kahura #5 Baraka Maina #6 Haizley Bartlett #7 Ryder Morgan #11 Michael Wade #12 Calan Diprose #13 Mikey Moses #15 Elijah Moore #22 Ky-Mani Kaumoana
Coach: Malachi Tulafono Asst Coach: Jamie Reddish Manager: Liz Kelso	Coach: Sam Twomey Asst Coach: Ed Wallace Manager: Paula Tala	Coach: Stefan Bigio Manager: Saga Vaisagote-Frost	Coach: Michael Wade Asst Coach: Harlan Roudon Manager: Laura Wade

Men's Pool D

Nelson	Otago	Waikato	Hawke's Bay
Adam Ward Akito Collins Ashton Walker Brodie Materoa Elijah Inwood Hayden Jones Hunter Taylor Jack Mellor Jerome Sinclair Larz Wadsworth Rihare Tanoa	#5 Tukarepa Nikora-Nimarota #6 Oak Chisholm #7 Luca Albert #8 George Lynskey #9 Carlos Dean #10 Oscar Tate #11 Max Congdon #12 Harry Townsend #13 Harry Bezett #30 Boston Paerata #31 Alex Gordon #32 Toby Hunt	Bryson Herewini Connor McKay Cooper Clark Cooper Watt Houkura Lloyd Korbyn Leonard Noah Heke Val Dean Xavier Rutene	#2 Kingston Byrne #3 Gyle Adams #4 Luke Payne #6 Jake Smith #7 Harry Keighley #8 Eddie Deck #9 Mads Averhof #10 Reuben Fey #14 Josaiah Hema #19 Isaac Allan
Coach: Carlo Varricchio Manager: Anthony Williams	Coach: Sam Fielding Asst Coach: Toby Lewis Manager: Rebecca Moon	Coach: Brandyn Were Asst Coach: Anthony Corban Manager: Kirby Leonard	Coach: James Henare Asst Coach: Hamimora Miringorangi Manager: Michelle Fey

Roster Check - Women



Women's Pool A

Waikato	Tauranga	Canterbury	Wellington
#4 Ngahirata Jennings-Haumaha	#4 Waikimihia Douglas-Karauna	#4 Anika Shaw	Asha Young
#5 Teia Koopu	#5 Ellie Porter	#5 Eva Jeffries	Ebony Mason
#6 Kahurangi Taute-Collier	#6 Jada Ormsby	#6 Ophelia Powell	Fo'i Lemana
#7 Keija Miringaorangi	#7 Graecyn Parahi	#7 Rafferty Powell	Isabel To'ia
#8 Taylah Wallace	#8 Shamar Broughton	#8 Niamh Chamberlain	Kahsia Bailey-Nowell
#9 Mia Christensen	#9 Rosa Hingston	#9 Sara Buckley	Maia Taylor
#11 Lily Ashton	#10 Areta Kahura	#10 Hannah Toli	Matilda Bublitz
#12 Keira Lazaro	#11 Charis Broughton	#11 Ava Jones	Nahala Toeleiu
#13 Aotea Nordstrom	#13 Isabella Gillard	#13 Harper McDonald	Portia McLean
		#14 Emilia Ainley	Tapuitea Matatia
		#15 Yasmin Larry	Vera Schmidt
			Zara Thomas
Coach: Anthony Corban Asst Coach: Brandyn Were Manager: Loren Miringaorangi	Coach: Jeanna Cooney Asst Coach: Joseph Broughton Manager: Tarsha Ormsby	Coach: Dave Emmerins Asst Coach: Karereatua Williams Manager: Liz Righton	Coach: Salo Taufale Manager: Brenda Hughes

Harbour	Otago	Auckland
#0 Lisa Gear	#1 Issy Kerr	#2 Abby Laird
#4 Ashleigh Tuumaialu	#2 Maddie Kerr	#3 Georgina Lautua
#6 Ruby Railton	#4 Ruby Fox	#4 Odile Dolon
#15 Brigid Mcmillan	#5 Eve Tonascia	#9 Charlene Masiutama
#23 Imani Rasmussen	#7 Shanti Kara	#11 Beautiful Campbell
#24 Katie Moors	#8 Emily Cooney	#25 Talia Vea
#32 Sienna Maurice	#9 Kiana Brown	#31 Lucy Ward
#35 Giselle Forster	#10 Freya Roberts	#47 Madeline Cox
#36 Amy McKenzie	#11 Hazel Mason	#51 Grady Nikoia
#43 Mela Andrews	#21 Caitlyn Ring	Harriate Heta
#44 Zenthia Stowers		Marietta Mataafa
Anahera Worsfold		
Coach: Darci Finnigan Asst Coach: Riana Matesini Manager: Beth Railton	Coach: Alf Arlidge Asst Coach: Lane Sievwright Manager: Jodi Brown	Coach: Justine Reed Manager: Saga Vaisagote-Frost

VENUE AND GAME INFO



• VENUE

- Venue address – 17 Parumoana Street, Porirua
- Venue open and closure times – 30mins pre first round and post last round
- Days 3 – Entrance will be around the back of the venue due to venue not opening to the public until 8am.
- Venue entrances & Door charge – No door charge
- Tournament office location – Upstairs in Meeting Room 1
- Placement of noticeboard for tournament info – Foyer
- Changing rooms and toilets – Near Court 2
- Video taping – away from impeding spectators, no on court video taping
- Clean up your benches – quick transitions, clean before you leave
- Evacuation Plan – follow venue staff instructions



• VENUE

- Venue want to stress that if teams are bring their own balls into the venue that **there is to be no bouncing of balls in the corridor**
- Also there is to be no training/warming up in the corrdior as this presents a H&S Risk for anyone else in the public trying to use the corridor
- Aquatic Centre/Pool on site - A discounted \$2 for individual entry, which teams will pay when they enter at the main reception area.
- Cafe on site – Hours are: Friday & Monday – 7am – 5pm. Saturday & Sunday 8am – 4pm
- Plenty of Free Parking at the venue
- Eskies in the corridor to fill water bottles
- Bags of Ice will be pre-filled and available in the first aid room, just off Court 3.
- Blood Kit in Court 4 area & Court 2
- No Glory League Cameras in venue.

COURT LAYOUT

Te Rauparaha

- 1 | 2 | 3 | 4

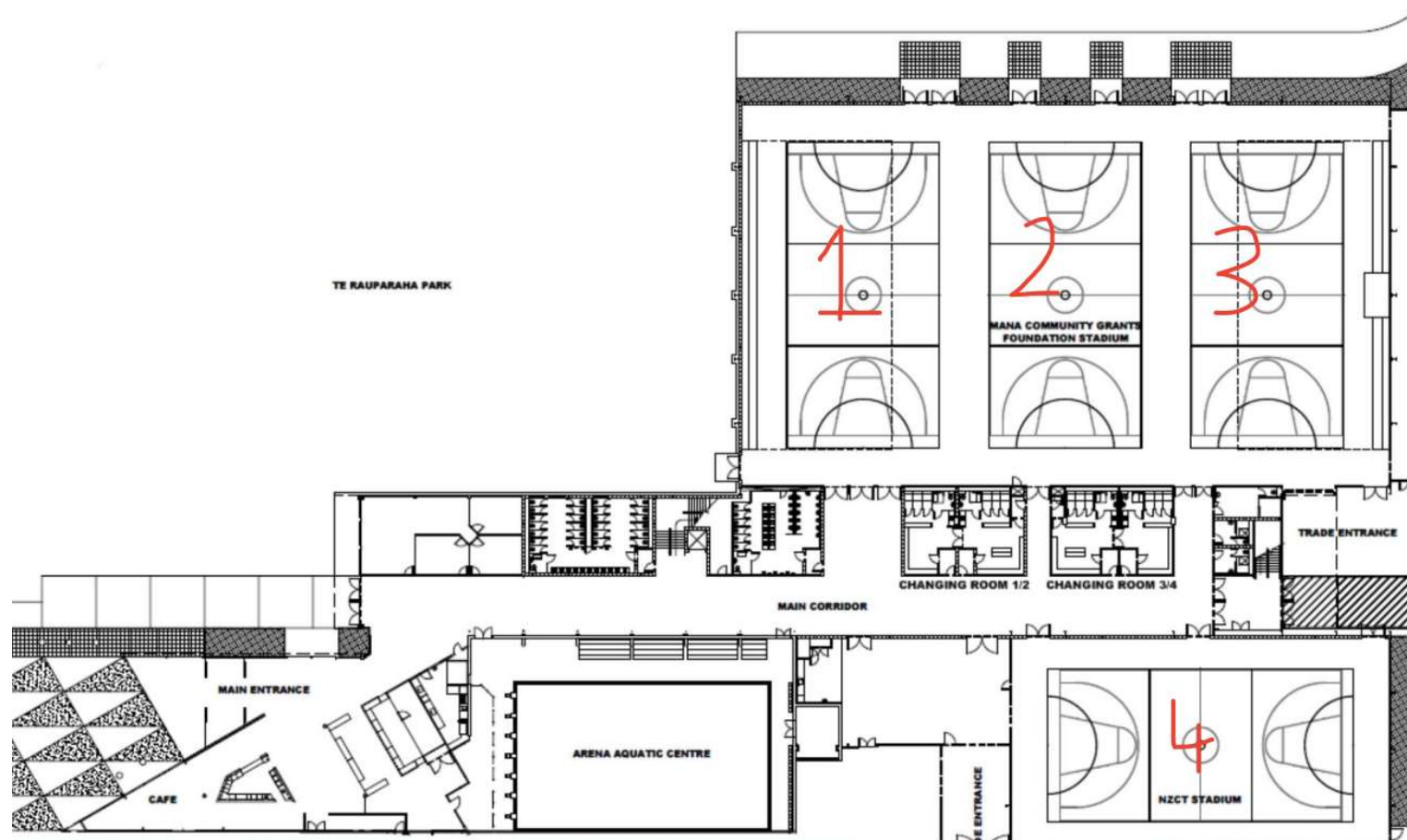

- We will have our Official Apparel partner iAthletic on site selling merchandise throughout the tournament
- They will be set up in the foyer area near the courts – will be easy to spot.

VENUE AND GAME INFO



MEDICAL

- Basic first aid – Wellington Sports Medicine
- Blood kit - available at each Court 2 & 4
- Ice – Available from the first aid room

MEDICAL CONTACTS

- Hospital – Kenepuru Community Hospital, 16 Hospital Drive, Kenepuru, Porirua 5022
- Physio – By Court 3 in the first aid room.
- Dentist – Sunshine Dental Porirua, 4 Lydney Place North, Porirua City Centre, Porirua 5022



Wellington Sports Medicine

- Will have a designated, tournament-specific physiotherapist working each day
- Hours available:
 - Friday 29th May – 8.15am - 9.15pm
 - Saturday 30th May – 8.15am - 9.15pm
 - Sunday 31st May – 7.30am - 10pm
 - Monday 1st June – 7.30am - 8.30pm

Services include:

- On-site assessment, treatment, rehabilitation and advice for acute and pre-existing conditions.
- ACC registration for eligible injuries along with relevant treatment for the injury (this can include massage where appropriate)
- Strapping (tape is provided as part of the service)
- Triage with onward referral if needed (e.g., imaging or specialist referrals)

FINDING INFORMATION



WHERE TO FIND ALL INFO

- www.nz.basketball all tourney info and link to online draw and results / Livestream
- All of our photos will be uploaded to Flickr – search for Basketball New Zealand
- [@BasketballNZ](https://www.instagram.com/BasketballNZ) for Instagram & Facebook
- **GAMEDAY APP – ALL DRAWS / RESULTS IN REAL TIME**

The image displays four sequential screenshots of the GameDay app interface on an iPhone. The first screenshot shows the App Store search results for 'GameDay App' by GameDay, with the app icon and 'OPEN' button circled in red. The second screenshot shows the app's search screen with 'league name' in the search bar and 'Leagues' selected in the filter tabs. The third screenshot shows search results for 'bbnz' with 'BBNZ Tournaments' circled in red. The fourth screenshot shows the 'BBNZ Tournaments' page with '2021 Aon U19 Nationals Mens' and '2021 Aon U19 Nationals Womens' circled in red. Red circles highlight key UI elements: the search bar, filter tabs, search results, and the 'Teams' icon in the bottom navigation bar.

COMPETITIONS INFO



- **The tournament will use Basketball New Zealand Regulations, FIBA Rules, Sport Integrity Commission Policies and BBNZ's Match Fixing Policy.**
- **Times**
 - Warm Up - minimum of 10 minutes
 - Playing Time - 4 x 10 minute stop clock quarters
 - Half Time - 5 minutes
 - Quarter Time Intervals - 2 minutes
 - Extra Periods - 5 minutes
 - Extra Period Intervals - 2 minutes
- **Sitting at the scorebench and In the event of a clash**
 - Team A **MUST** sit to the left - Team A is to wear their light coloured uniforms
 - Team B **MUST** sit to the right - Team B is to wear their dark coloured uniforms
 - Please have both uniforms on you where possible, so if there are any clashes, there are options to change colours.
- **No Coaches are to wear BBNZ gear while coaching – Please wear your Association Branded Gear**
- **No Caps allowed to be worn while coaching**



COMPETITIONS INFO BALLS & SCORESHEET



SCORESHEETS & BALLS

- Procedure for game balls – Referees will store and bring to games
- Procedure for scoresheets – All Scoresheets will be done on Glory League Scorekeeper (you can check the scoresheet at anytime on the ipads), scoresheets can be available on request. Email jay@nz.basketball
- Scorebench duty roster – teams be aware of your duties post match!
- **UNIFORMS, TEAM LISTS AND NUMBERS**
 - Online Database Can Incorrectly Fill Team List From Time To Time
 - Check Every Team List On Glory League Each Game
 - Playing Numbers Can Change
 - If You Are On Livestream Please Let Us Know Number Changes



COMPETITIONS INFO GLORY LEAGUE



GLORY LEAGUE & BENCH

- Please take Scorebench duty seriously!
- This is the official scoresheet!!!
- No phones or distractions
- Flyers at each scorebench
- Flyers at each scorebench
- Ask Floor controller if you need help.

SCOREKEEPER
FIBA SCORING GAME SET UP



1. Ensure that each team is assigned different team colours



2. Tap in all active players



3. Tap in the starting five of each team



Scoring a Game
With SCOREKEEPER LITE



- 1 Choose Game
- 2 Team Setup
- 3 Team Arrows
- 4 Start Game
- 5 Add Points
- 6 Choose Made/ Missed
- 7 Add Foul
- 8 Choose Fouler
- 9 Foul Type
- 10 Submit Game

1 Choose Game

Select the game then push Start >>>

2 Team Setup

All players must be set to 'Playing'. Tap the 'Not playing' button to set a player to 'Playing'. Tap a number to change a player's number. push Next >>>

3 Team Arrows & Start

Ensure teams are pointing in the correct direction. Push the flip button. When the players take the court, Tap the Start button.

5 Add Points

When a 2pt, 3pt or 1pt Shot is Made, TAP the corresponding button.

6 Choose Made or Missed

Tap the shooter's number.

7 Tap To Add Foul

When the referee blows the whistle to signal a foul, Tap the Foul Button on the bottom right of the iPad.

8 Choose the Fouler

Choose the player who fouled.

9 Choose Foul Type

Tap the big 'FOUL' button, Unless the referee advises otherwise.

10 Submit Game

Once the game is over, tap the Submit button up at the top right corner of the interface.

Next Quarter

Once you reach the end of the period, hit the right arrow.

Undo

If you make a mistake, tap the undo button. After you've Undone your Mistake, you can enter the correct event again.



COMPETITIONS INFO

DRAW



DRAW STRUCTURES

- **MENS: 16 Teams**

- 1 round robin - 4 pools of 4
- 1st in each pool qualify for the 1-8 QF-SF-F's
- 2nd & 3rd in each pool play a Preliminary Quarter Final
- Winners advance to 1-8 QF-SF-F's
- Losers progress to 9-16 QF-SF-F's
- 4th in each pool progress to 9-16 QF-SF-F's

- **WOMENS: 7 Teams**

- 1 round robin – 1 pool of 7
- 1st – 4th Round Robin play in 1-4 SF-F
- 6th RR v 7th Round Robin play 5-7 SF, winner to play 5th RR for 5th & 6th, loser finishes 7th

CLASSIFICATION / STANDING OF TEAMS



- **CLASSIFICATION OF TEAMS**
- FIBA Rules will be used

- **GAME POINTS**
 - 2 points for a win
 - 1 point for loss/default (fewer than 2 players on the playing court ready to play.)
 - 0 for forfeit of Game & \$500 fine (20-0 scoreline)

- **CLASSIFICATIONS**
 - 2 way tie – win – loss record between the teams tied
 - If 2 or more teams have the same win-loss record of all games in the group, the game(s) between these 2 or more teams shall decide on the classification. If the 2 or more teams have the same win-loss record of the games between them, further criteria will be applied
 - Higher goal difference – only in the games between them.
 - Further criteria is applied after that.

LIVE STREAMING & LIVE STATS / PHOTOS



- **LIVE STATS**

- Confirmed for Sunday Evening Semi Finals & for two grand finals
- TBC for Monday morning Semi Finals

- **LIVE STREAMING**

- No public or private livestreaming please.
- Day 1, 2 3 & 4 – Courts 1, 2 & 4
- Livestreaming Draw on Website (Games Highlighted Yellow will be livestreamed)
- www.nz.basketball/tv or,
- Whakaata Māori YouTube Channel
- The two Grand Finals will be on Whakaata Māori Linear TV (Women's Live & Men's Delayed)

- **PHOTOS / VIDEOGRAPHY**

- BBNZ Contractors onsite for Photos and Videography
- All media **must have** gone through the media accreditation process and be signed off by our Marketing & Communications team. Those who haven't can't capture any content.

- **LIVE STREAMING – CONTINUED**

- Although the **NZ Sport Collective Charter** is specifically referencing school events, we apply the essence of it to our other youth events too.
- We align with the principles and guidelines of Sport NZ’s ‘Keep up with the play’ and ‘Balance is Better’ initiatives, positive parental behaviour and support, and will make every effort to align our broadcast messaging to those values.
- Be aware of what you, your team and spectators are posting – please keep it positive
- No public or private streaming as we do not have control of the space and place this goes too, amongst other reasons.
- We want everything to be positive as we all lift the brand of Basketball in NZ
- If you have any questions, please address BBNZ staff before taking opinions or false statements onto public platforms

If you have anything you want to pass onto commentators, like pronunciation or facts about players then please do so 😊

AWARDS CEREMONY



- **AWARDS CEREMONY**
 - After Men's Grand Final – if possible please stick around!

- **AWARDS FOR THE FOLLOWING**
 - Champions of each gender x 16
 - Runners up of each gender x 16
 - Third Place of each gender x16
 - Grand Final officials x3 per Final
 - Foot Locker Defensive Player of the Tournament – One Per Gender
 - All Star 5 x5 per Gender
 - MVP x1 per Gender

REFEREE INFORMATION



- **Technical Commissioner**
 - **Campbell Marsters**
- **Mouthguards**
 - as per the BBNZ policy these should be worn at all times. We will be working with coaches and management on this and will only at a last resort, sub players out (which will not be occurring at the end of the game)
- **Uniforms**
 - In the event of a clash – team A will need to wear a light strip. However, we ask that both teams work together to ensure we do not have to resort to this rule. A clash is only similar colours not two dark or light shades
 - Undergarments – Compression Garments are allowed, but all players on the team must have the same colour. Only compression garments are permitted, not T-shirts, etc.
- **Behaviour**
 - Coach, Player and Supporter behaviour. As per the BBNZ Code of Conduct, poor behaviour will not be tolerated. A reminder that we all have an onus to present the best possible image of our sport.



Referee info continued

- **Team management roles – The technical rules are**
 - The Head Coach is the only team manager who can by rule speak to the referee. In doing so this is to ask a question in a dead ball situation.
 - The Assistant Coach may only stand if the Head Coach is sitting and can only speak to their players (not the referees).
 - Team management can approach the score table in a dead ball situation if any questions. However, if there is a concern, the Head Coach needs to raise this with the referees (in a polite manner in a dead ball opportunity). Please ensure that you raise concerns asap, as some errors are only correctable in a limited time period.
- **Game Protests**
 - Once the scoresheet is signed by the referees, then the final noted game score stands. There are no game protests, please be aware of the rules above when you have a score or bench concern.
- **Judicial**
 - For any Judicial Matters, please speak to Basketball New Zealand Staff.
- **Ejections**
 - Due to a disqualifying foul, will also be looked at. (These differ to someone who has had a game disqualification as a result of 2 technical fouls or unsportsmanlike combo)

COACH INFORMATION



- NO CAPS or BEANIES etc
- NO BBNZ GEAR (while coaching)
- Dress in association branded gear if possible

BBNZ Code of Conduct



- Basketball New Zealand has a new Code of Conduct & Safeguarding Policy
- This is available to read on the BBNZ Website
- The Code of Conduct prohibits any abusive behaviour towards players, referees, spectators, officials. Any behaviour like this **will not be tolerated**
- StopLine is an independent, confidential disclosure service available to the basketball community 24 hours a day, 365 days a year. Feel free to contact StopLine at anytime is something doesn't seem right.
- Posters with the number/QR Code to do so will be up around the venue.



BASKETBALL
New Zealand

ANY QUESTIONS??





BASKETBALL
New Zealand

FROM
PORIRUA BASKETBALL
ASSOCIATION &
BASKETBALL NEW ZEALAND
GOOD LUCK TO ALL TEAMS!

